



| Rev | Date | Description |
|-----|------|-------------|
| | | |
| | | |
| | | |
| | | |

ALL DIMENSIONS IN (mm)
UNLESS OTHERWISE SPECIFIED
BREAK ALL SHARP EDGES

TOLERANCES
(BEFORE PAINTING
& AFTER PLATING)
X ± 1.00
X.X ± 0.50
X.XX ± 0.10
ANGLES ± 0.5°

A01- RENDER

CLIENT: RFA1000

PROJ. NO.: TBA

PART NO.: --

Revision --

Page 1

600mm(W)x1515mm(H)x270mm(D)
DOUBLE SIDED GONDOLA BAY-NON PERFORATED
SLIMLINE - START BAY (PEARL WHITE)

PRODUCT CODE: **RFA1050**

Date: 19/06/2023

Drawn by DH

Checked by --

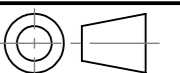

DO NOT SCALE

Scale@A3 1:20

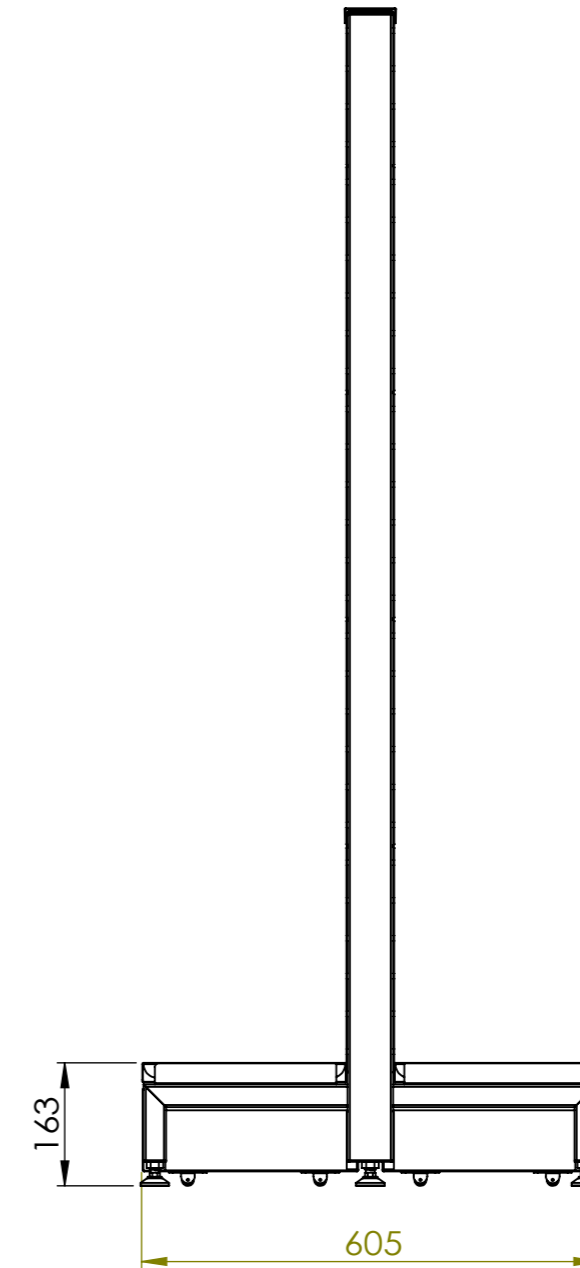
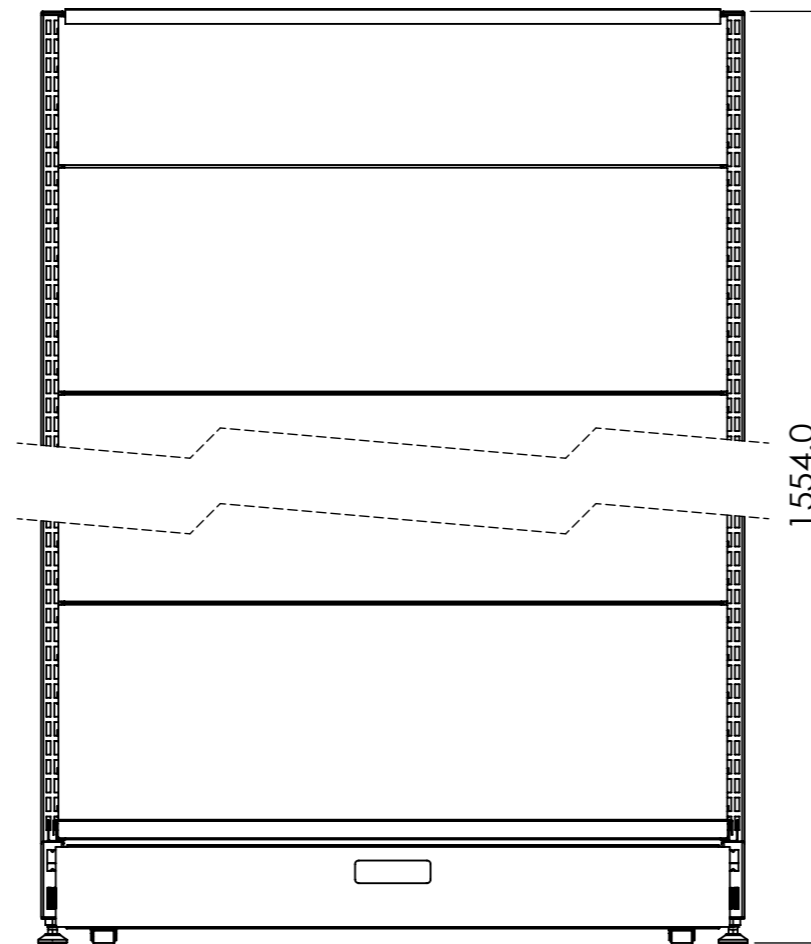
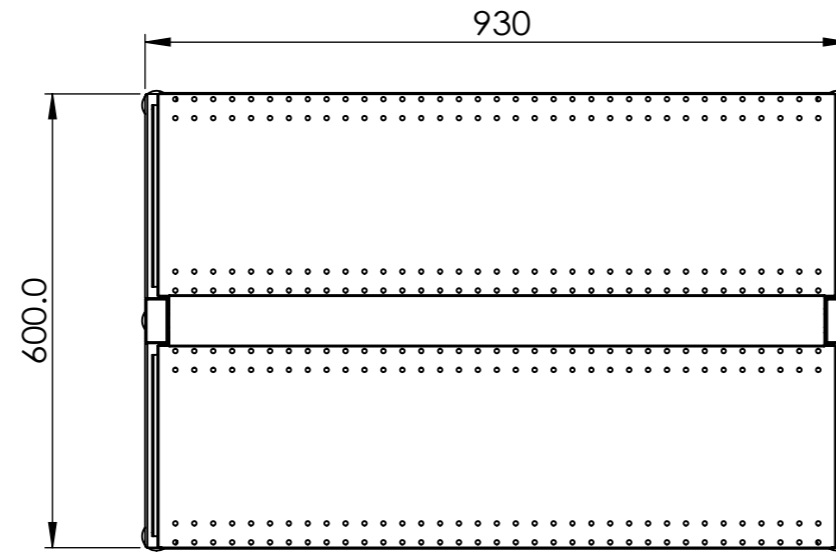
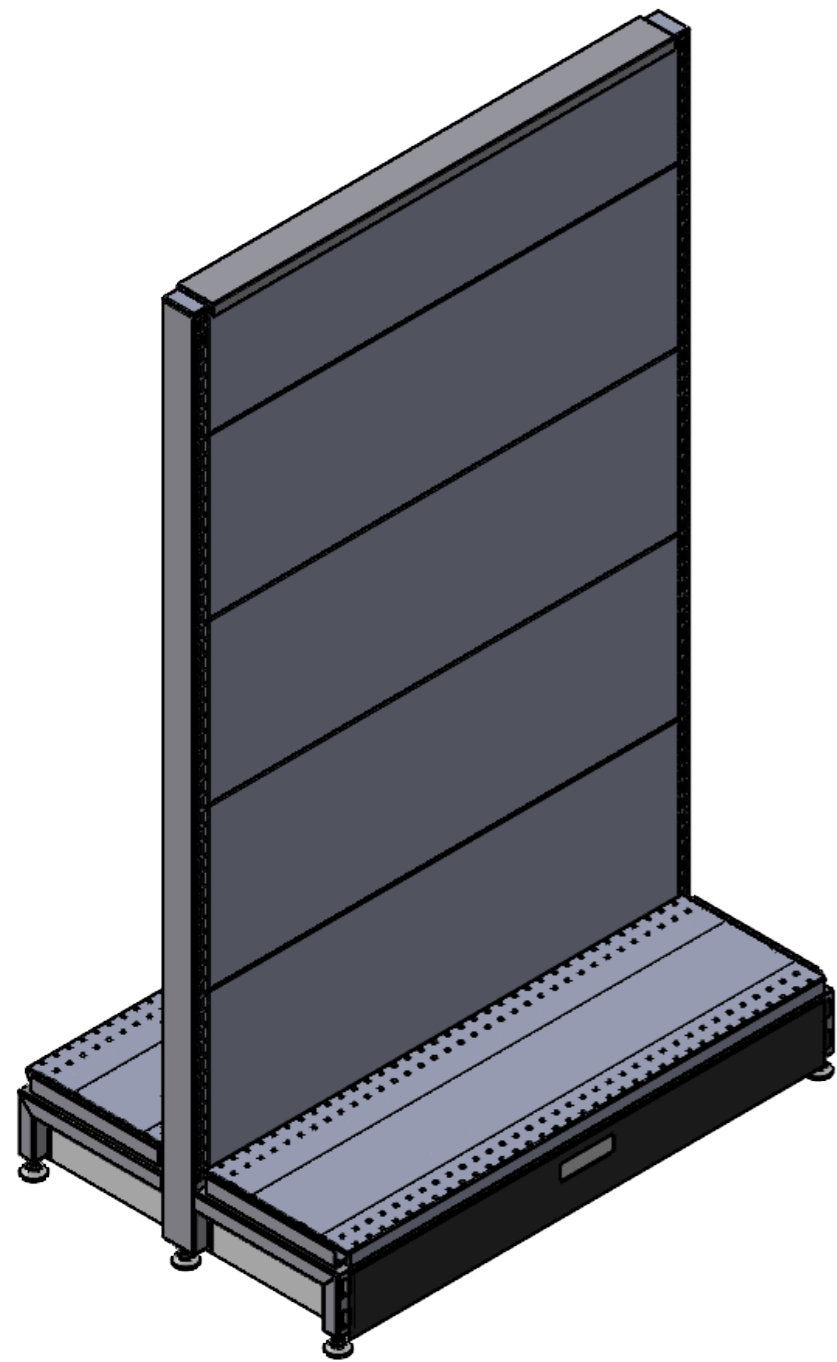

| Rev | Date | Description |
|-----|------|-------------|
| | | |
| | | |
| | | |

ALL DIMENSIONS IN (mm)
UNLESS OTHERWISE SPECIFIED
BREAK ALL SHARP EDGES

TOLERANCES
(BEFORE PAINTING
& AFTER PLATING)
X ± 1.00
X.X ± 0.50
X.XX ± 0.10
ANGLES ± 0.5°

A02- CLIENT
CLIENT: RFA1000
PROJ. NO.: TBA
PART NO.: --
Revision --
Page 2

| | | |
|--|------------------|---------------|
| 600mm(W)x1515mm(H)x270mm(D) DOUBLE SIDED GONDOLA BAY-NON PERFORATED SLIMLINE - START BAY (PEARL WHITE) | | |
| PRODUCT CODE: RFA1050 | Date: 19/06/2023 | |
| Drawn by: DH | Checked by: -- | Scale@A3 1:15 |

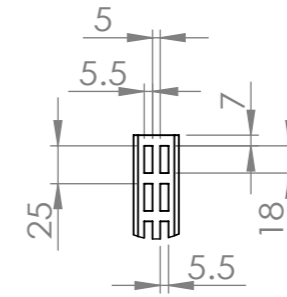
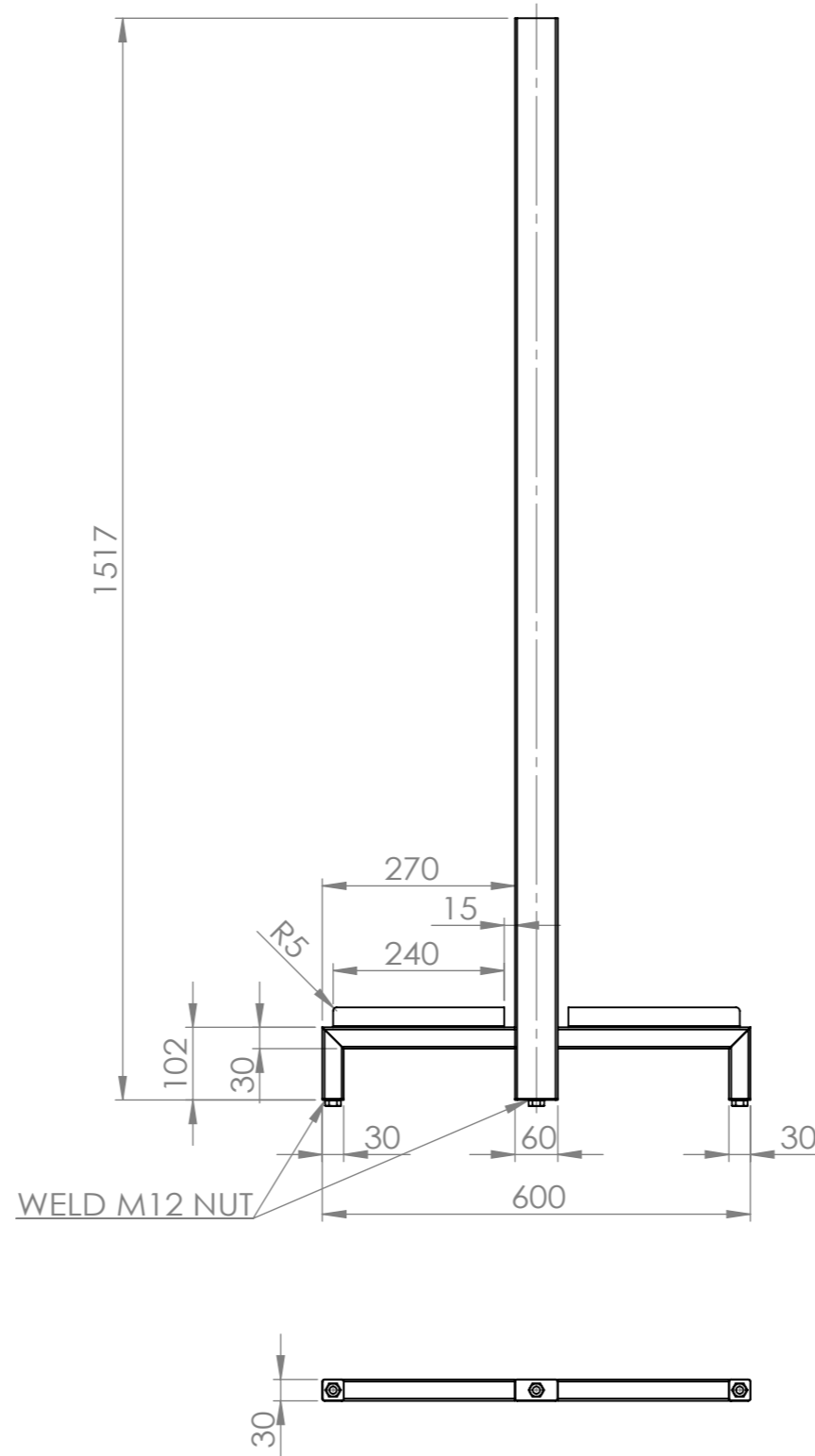
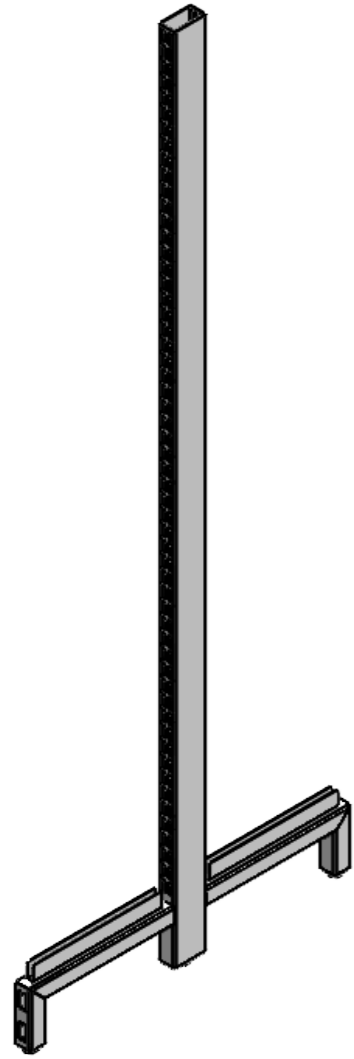

DETAIL G
SCALE 1 : 5

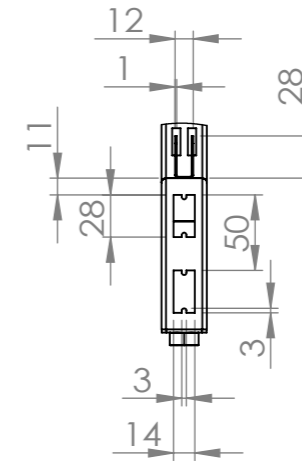

DETAIL F
SCALE 1 : 5

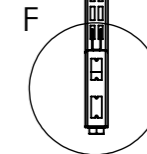
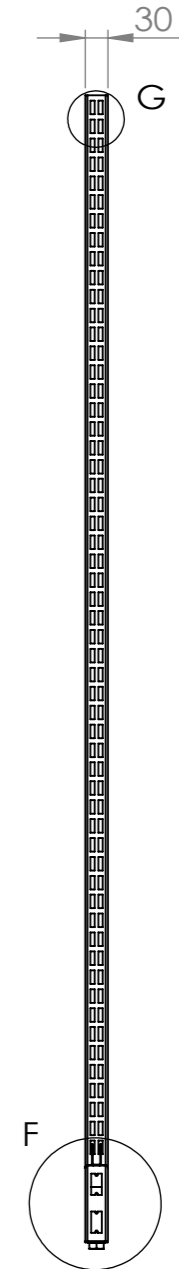

| Rev | Date | Description |
|-----|------|-------------|
| | | |
| | | |
| | | |

ALL DIMENSIONS IN (mm)
UNLESS OTHERWISE SPECIFIED
BREAK ALL SHARP EDGES

TOLERANCES
(BEFORE PAINTING
& AFTER PLATING)
X ± 1.00
X.X ± 0.50
X.XX ± 0.10
ANGLES ± 0.5°

A03- MECHANICAL

CLIENT: RFA1000

PROJ. NO.: TBA

PART NO.: --

Revision --

Page 3

600mm(W)x1515mm(H)x270mm(D)
DOUBLE SIDED GONDOLA BAY
270(W)x1517(H) DOUBLE SIDED POST (PEARL WHITE)

PRODUCT CODE: **RFA1120**

Date: 19/06/2023

Drawn by DH

Checked by --

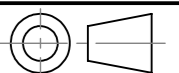

DO NOT SCALE

Scale@A3 1:10

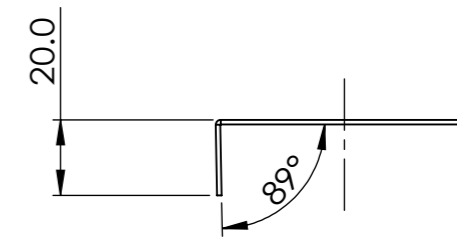
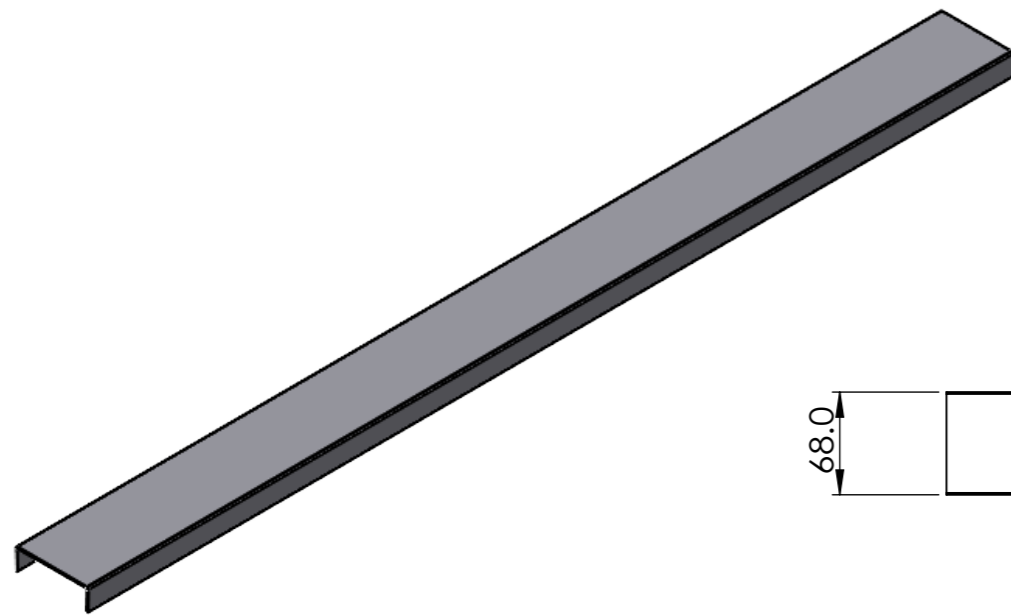

DETAIL R
SCALE 1 : 2

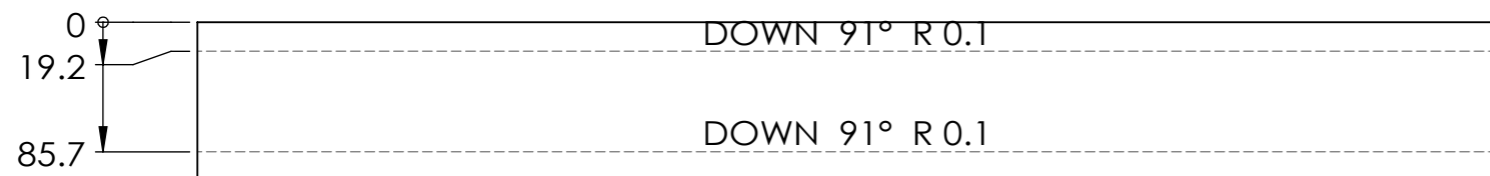
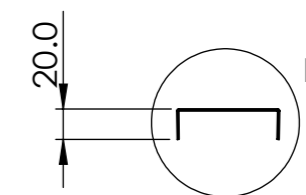
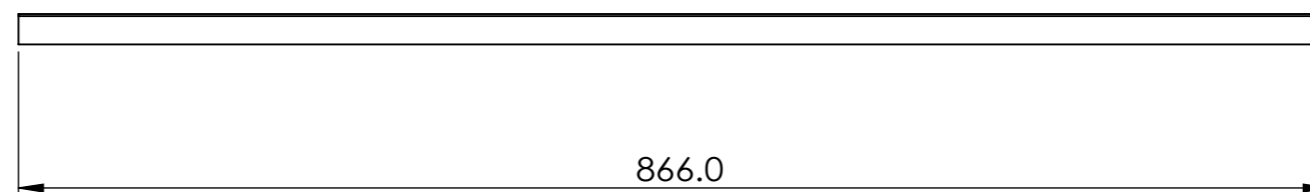

FLAT PATTERN: SHEET
SCALE 1:5

MATERIAL: MILD STEEL
1.2 THK
866 L x 104.9 W
↑↔GRN DIR

| Rev | Date | Description |
|-----|------|-------------|
| | | |
| | | |
| | | |

ALL DIMENSIONS IN (mm)
UNLESS OTHERWISE SPECIFIED
BREAK ALL SHARP EDGES

TOLERANCES
(BEFORE PAINTING
& AFTER PLATING)
X ± 1.00
X.X ± 0.50
X.XX ± 0.10
ANGLES ± 0.5°

A04- MECHANICAL

CLIENT: RFA1000

PROJ. NO.: TBA

PART NO.: --

Revision --

Page 4

600mm(W)x1515mm(H)x270mm(D)
DOUBLE SIDED GONDOLA BAY
TOP CAP-SLIMLINE 600mm (PEARL WHITE)

PRODUCT CODE: **RFA1136**

Date: 19/06/2023

Drawn by DH

Checked by --



DO NOT SCALE

Scale@A3 1:5

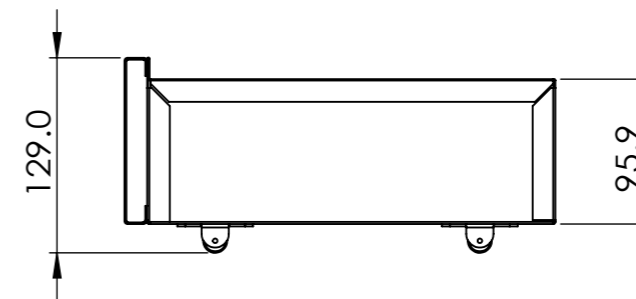
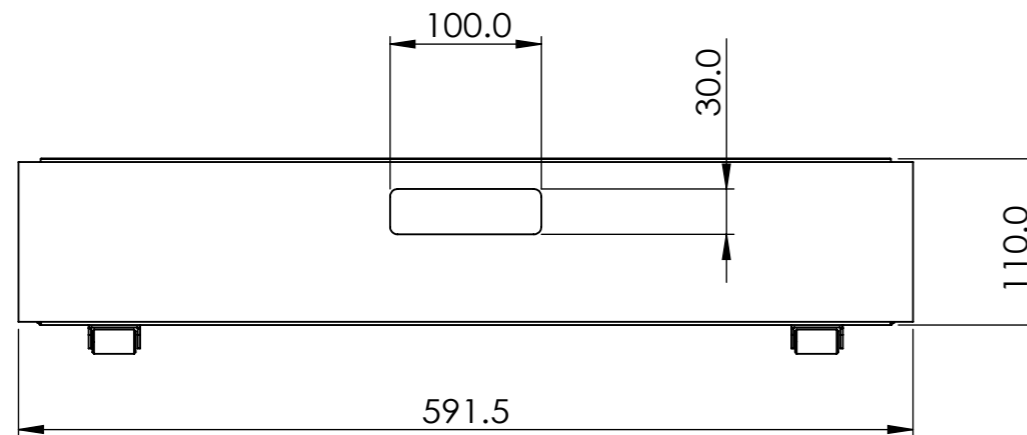
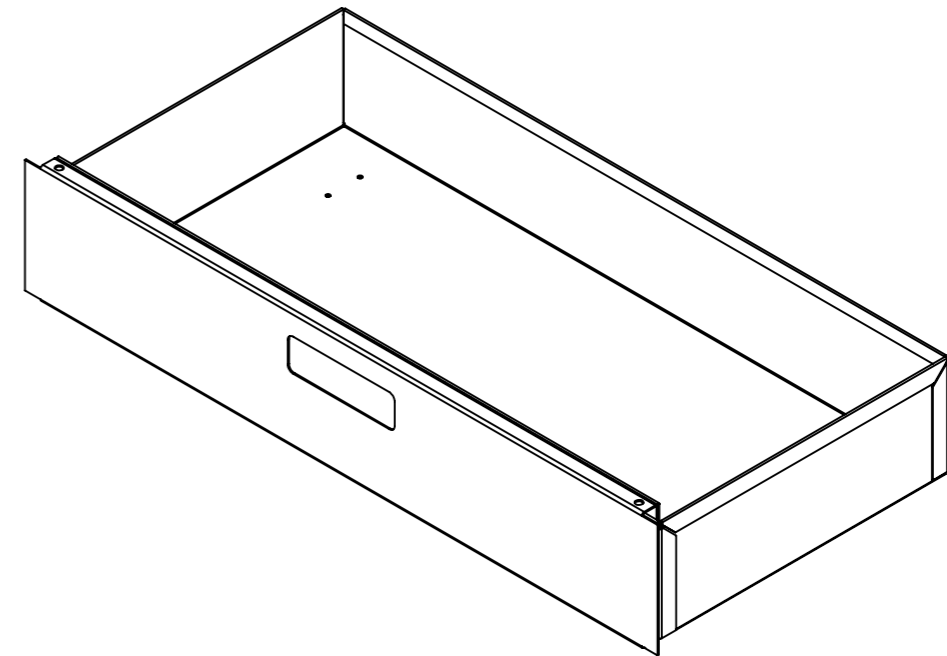

| Rev | Date | Description |
|-----|------|-------------|
| | | |
| | | |
| | | |

ALL DIMENSIONS IN (mm)
UNLESS OTHERWISE SPECIFIED
BREAK ALL SHARP EDGES

TOLERANCES
(BEFORE PAINTING
& AFTER PLATING)
X ± 1.00
X.X ± 0.50
X.XX ± 0.10
ANGLES ± 0.5°

A05- MECHANICAL

CLIENT: RFA1000

PROJ. NO.: TBA

PART NO.: --

Revision --

Page 5

600mm(W)x1515mm(H)x270mm(D)
DOUBLE SIDED GONDOLA BAY-PERFORATED
DRAWER SKIRT (MATTE BLACK)

PRODUCT CODE: **RFA1114**

Date: 19/06/2023

Drawn by DH

Checked by --

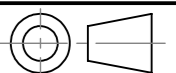

DO NOT SCALE

Scale@A3 1:5

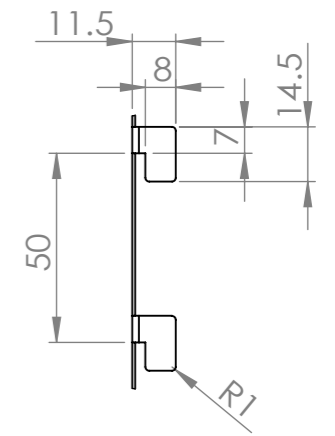
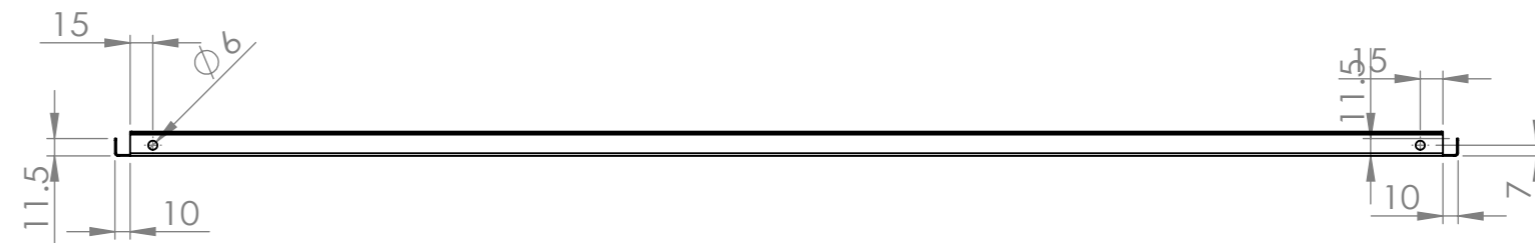
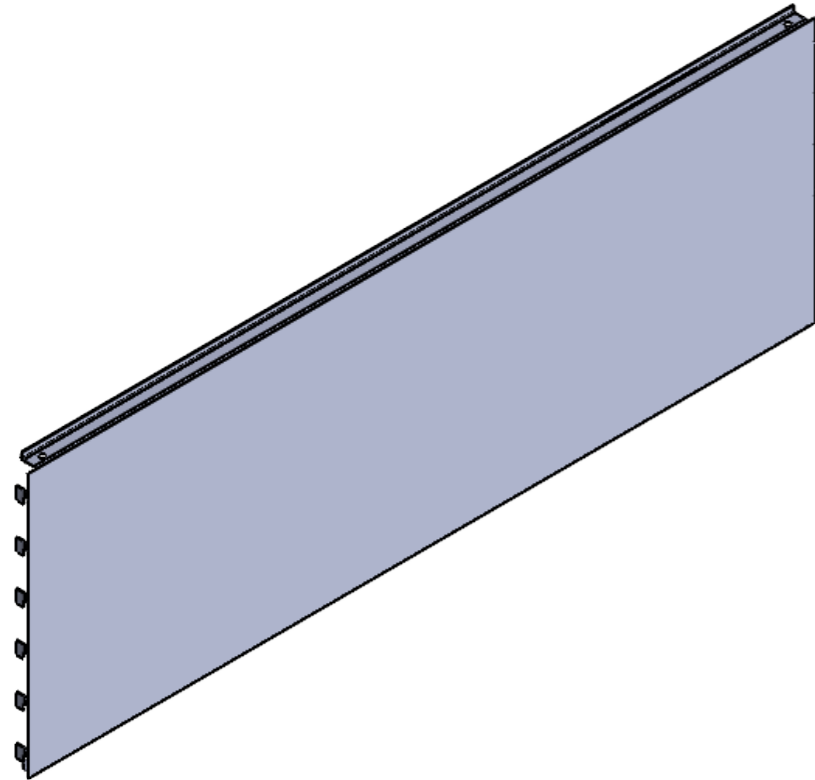

DETAIL M
SCALE 1 : 2

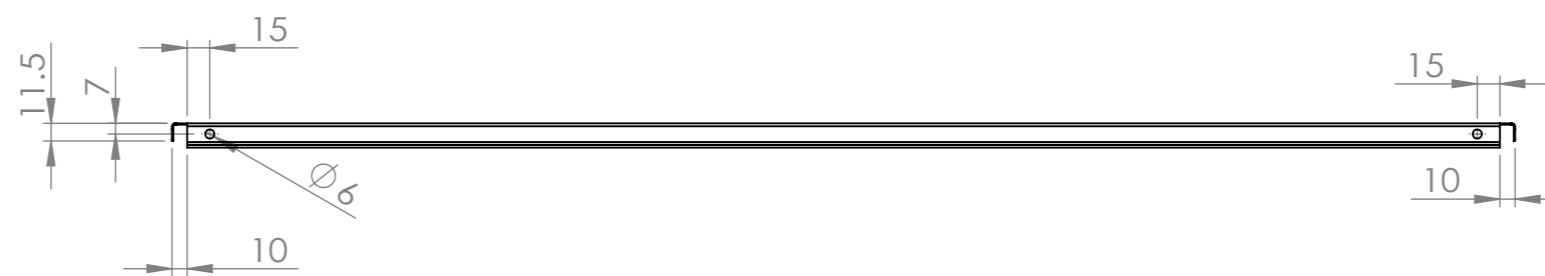
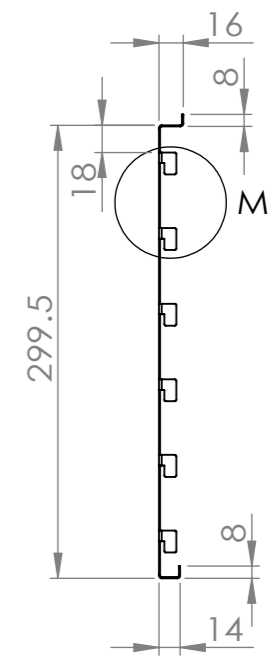
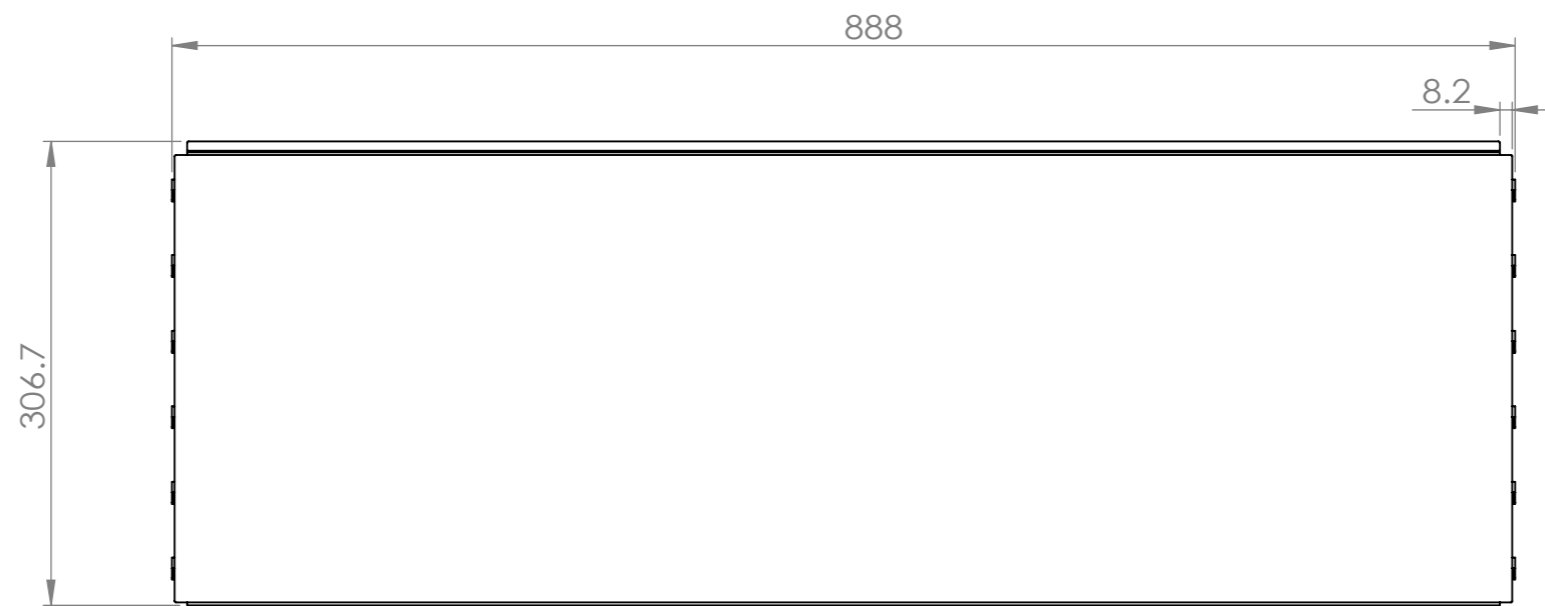

| Rev | Date | Description |
|-----|------|-------------|
| | | |
| | | |
| | | |

ALL DIMENSIONS IN (mm)
UNLESS OTHERWISE SPECIFIED
BREAK ALL SHARP EDGES

TOLERANCES
(BEFORE PAINTING
& AFTER PLATING)
X ± 1.00
X.X ± 0.50
X.XX ± 0.10
ANGLES ± 0.5°

A06- MECHANICAL

CLIENT: RFA1000

PROJ. NO.: TBA

PART NO.: --

Revision --

Page 6

600mm(W)x1515mm(H)x270mm(D)
DOUBLE SIDED GONDOLA BAY
600(W)x300(H) NON PERF. PANEL (PEARL WHITE)

PRODUCT CODE: **RFA1101**

Date: 19/06/2023

Drawn by DH

Checked by --

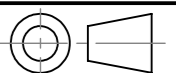

DO NOT SCALE

Scale@A3 1:5

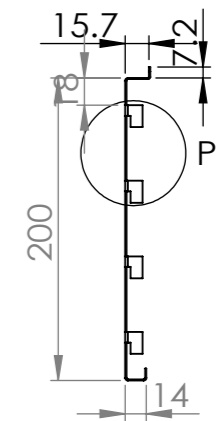
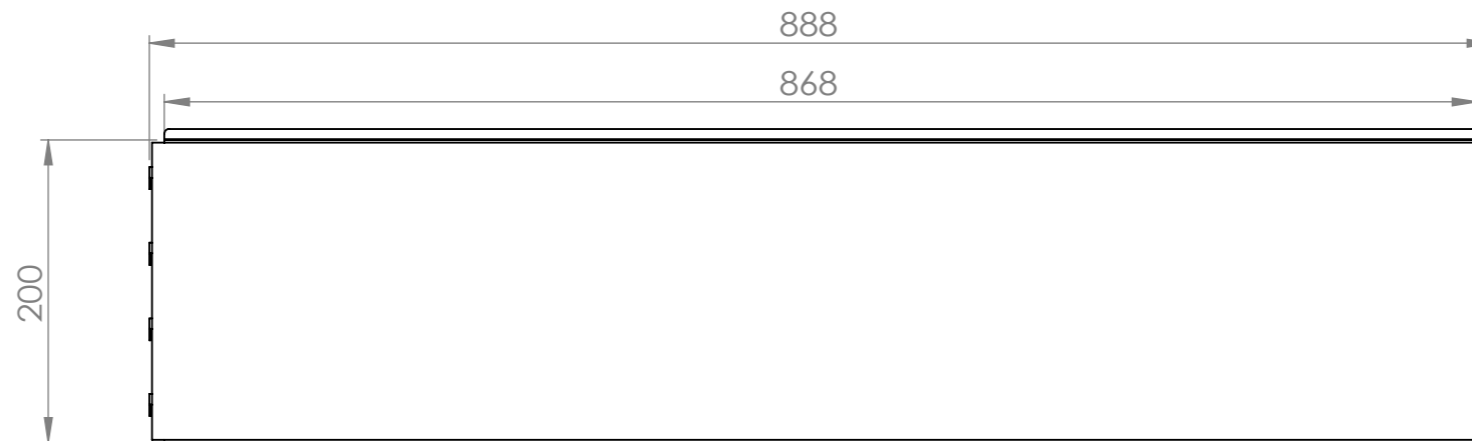
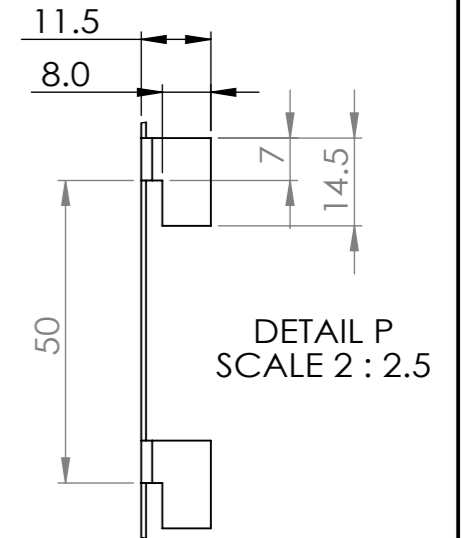
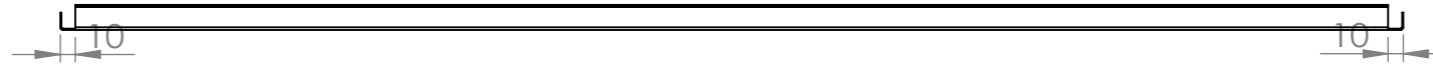
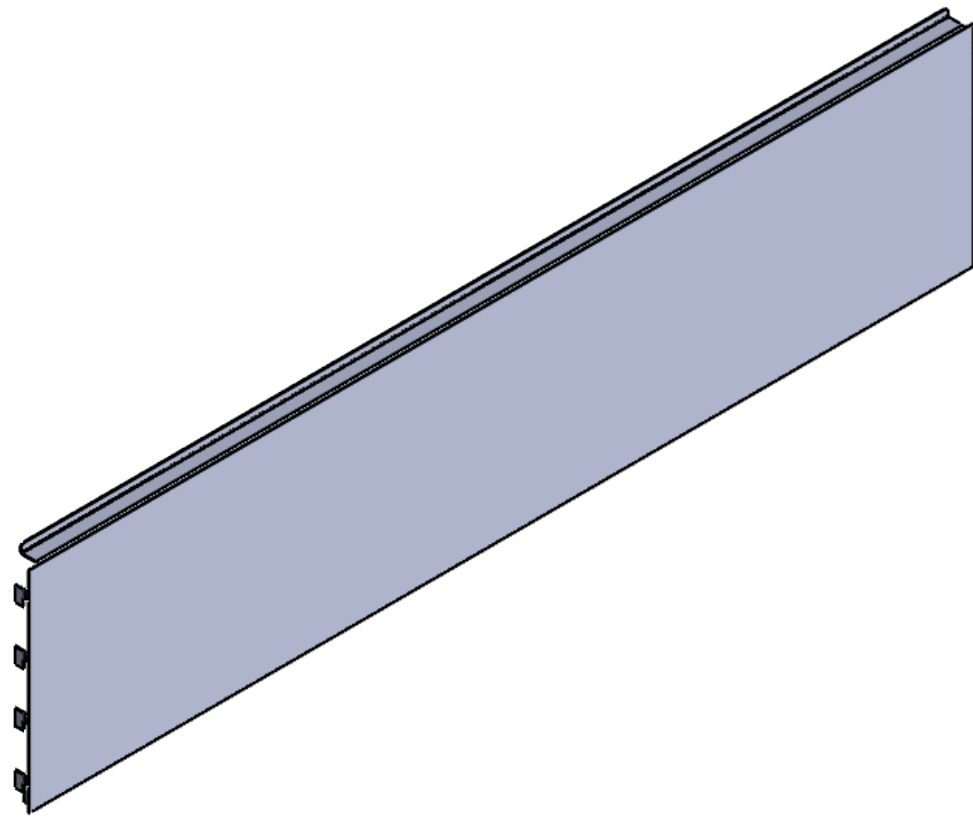

| Rev | Date | Description |
|-----|------|-------------|
| | | |
| | | |
| | | |

ALL DIMENSIONS IN (mm)
UNLESS OTHERWISE SPECIFIED
BREAK ALL SHARP EDGES

TOLERANCES
(BEFORE PAINTING
& AFTER PLATING)
X ± 1.00
X.X ± 0.50
X.XX ± 0.10
ANGLES ± 0.5°

A07- MECHANICAL

CLIENT: RFA1000

PROJ. NO.: TBA

PART NO.: --

Revision --

Page 7

600mm(W)x1515mm(H)x270mm(D)
DOUBLE SIDED GONDOLA BAY
600(W)x200(H) NON PERF. PANEL (PEARL WHITE)

PRODUCT CODE: **RFA1103**

Date: 19/06/2023

Drawn by DH

Checked by --

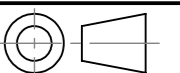

DO NOT SCALE

Scale@A3 1:5

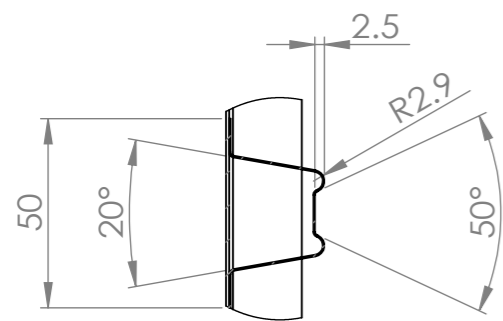
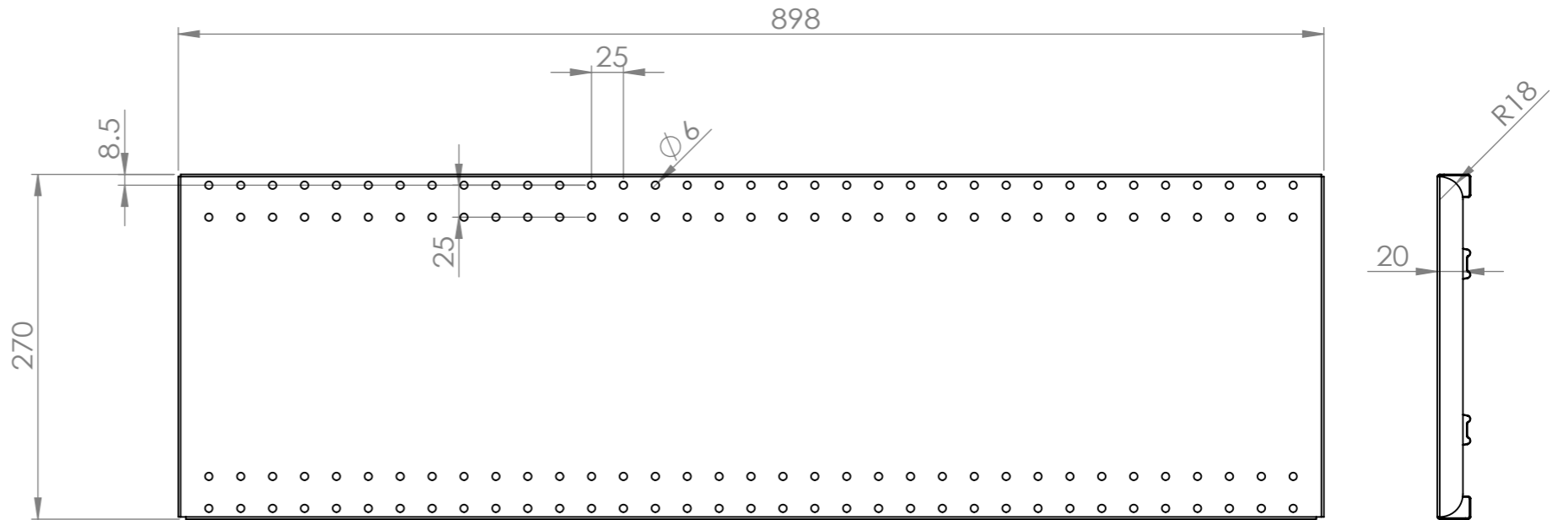
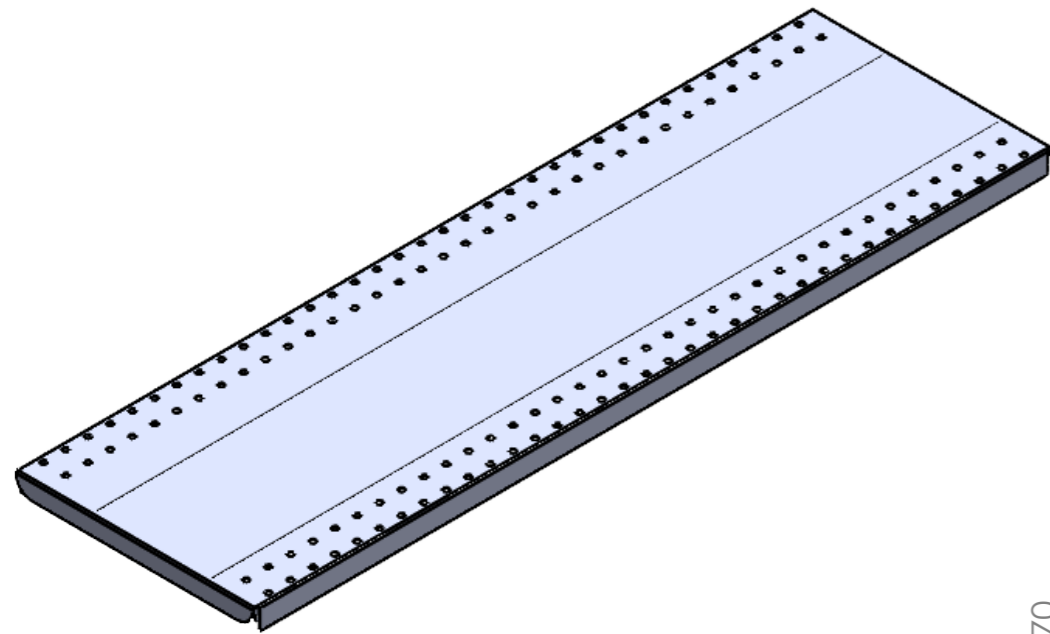

DETAIL K
SCALE 1 : 2

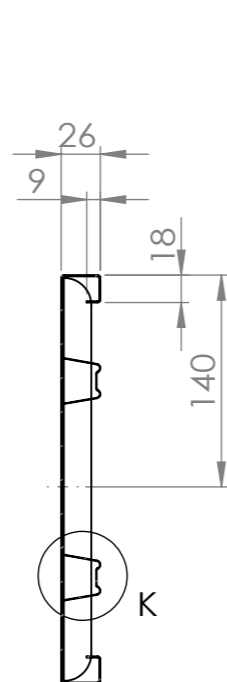

SECTION J-J

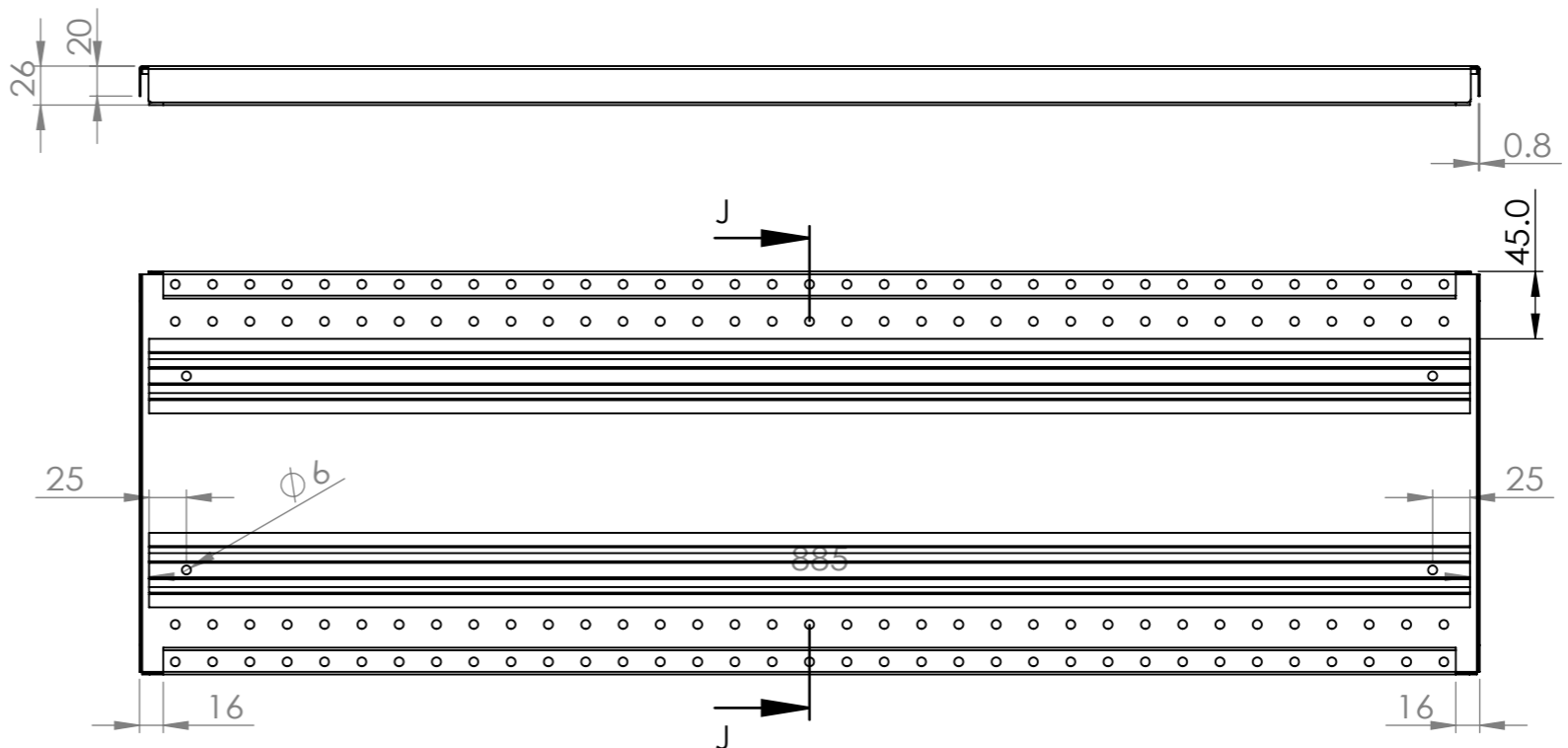

| Rev | Date | Description |
|-----|------|-------------|
| | | |
| | | |
| | | |

ALL DIMENSIONS IN (mm)
UNLESS OTHERWISE SPECIFIED
BREAK ALL SHARP EDGES

TOLERANCES
(BEFORE PAINTING
& AFTER PLATING)
X ± 1.00
X.X ± 0.50
X.XX ± 0.10
ANGLES ± 0.5°

A08- MECHANICAL

CLIENT: RFA1000

PROJ. NO.: TBA

PART NO.: --

Revision --

Page 8

600mm(W)x1515mm(H)x270mm(D)
DOUBLE SIDED GONDOLA BAY
600(W)x270(D) SHELF (PEARL WHITE)

PRODUCT CODE: **RFA1321**

Date: 19/06/2023

Drawn by DH

Checked by --

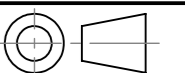

DO NOT SCALE

Scale@A3 1:5

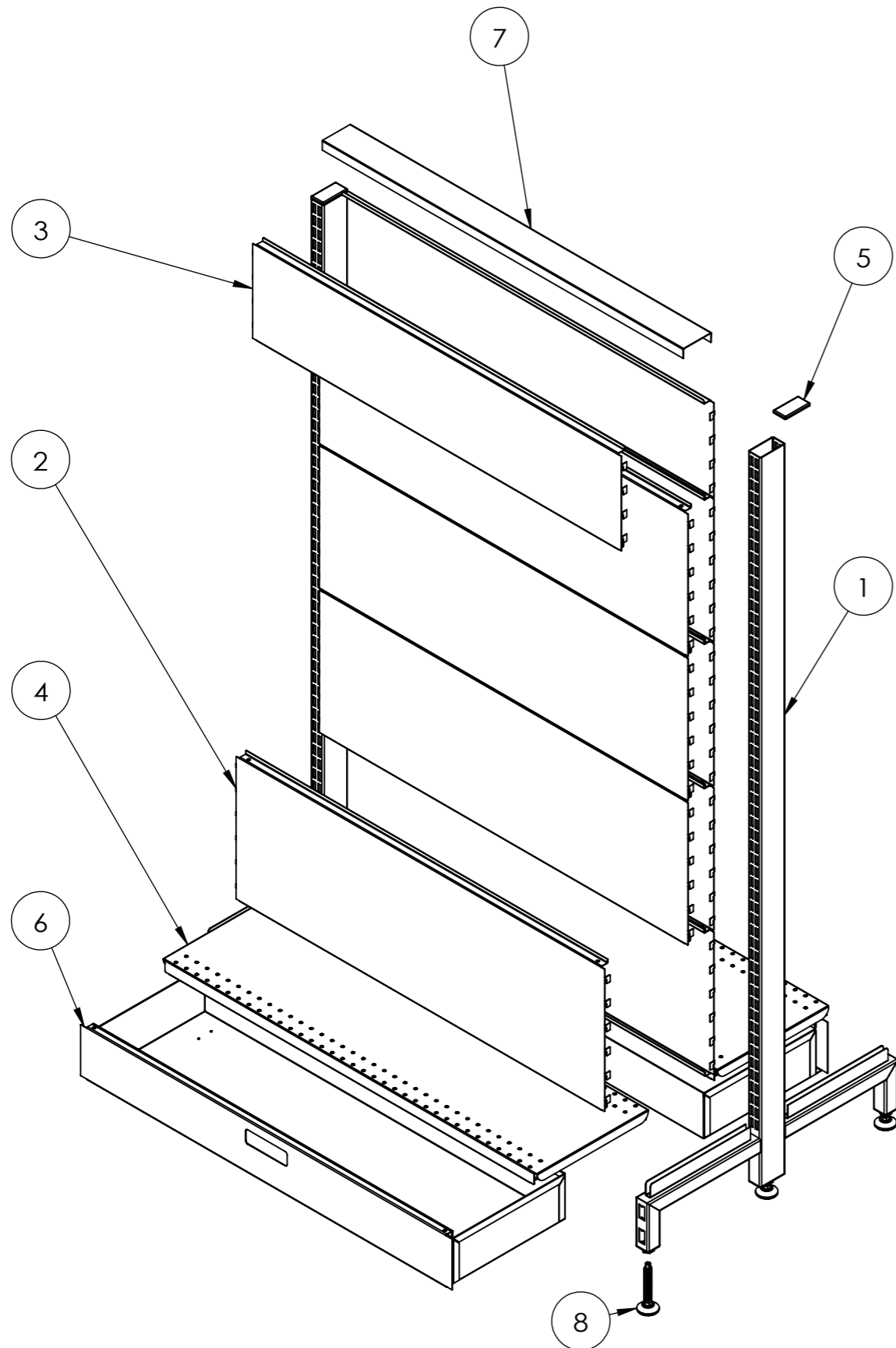

| ITEM NO. | DESCRIPTION | QTY. |
|----------|---|------|
| 1 | POST - DOUBLE SIDED GONDOLA - 1515 MM (H) - W/. 270 MM LEGS - PEARL WHITE | 2 |
| 2 | CLIP IN PANEL - 600(W) X 300(H) - NON PERFORATED - PEARL WHITE | 8 |
| 3 | CLIP IN PANEL - 600 MM (W) X 200 MM (H) - NON PERFORATED - PEARL WHITE | 2 |
| 4 | SHELF STEEL - 600 MM (W) X 270 MM (D) - PEARL WHITE | 2 |
| 5 | PLASTIC ENDCAP | 2 |
| 6 | SKIRT DRAWER BOX - 600mm | 2 |
| 7 | 600 MM (W) SLIMLINE INTERNAL TOP CAP CLIPPER - FOR DDS | 1 |
| 8 | M12 LEVELING FEET | 6 |

| Rev | Date | Description |
|-----|------|-------------|
| | | |
| | | |
| | | |
| | | |

